

# A133 Ipswich Road Scheme - Main Works

## Harwich Road Roundabout - St Andrews Avenue

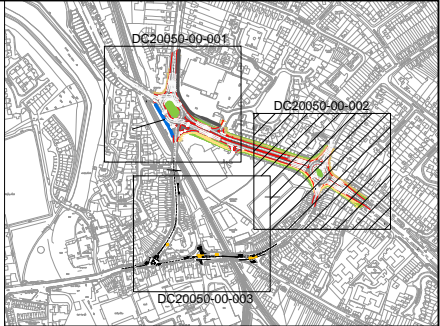
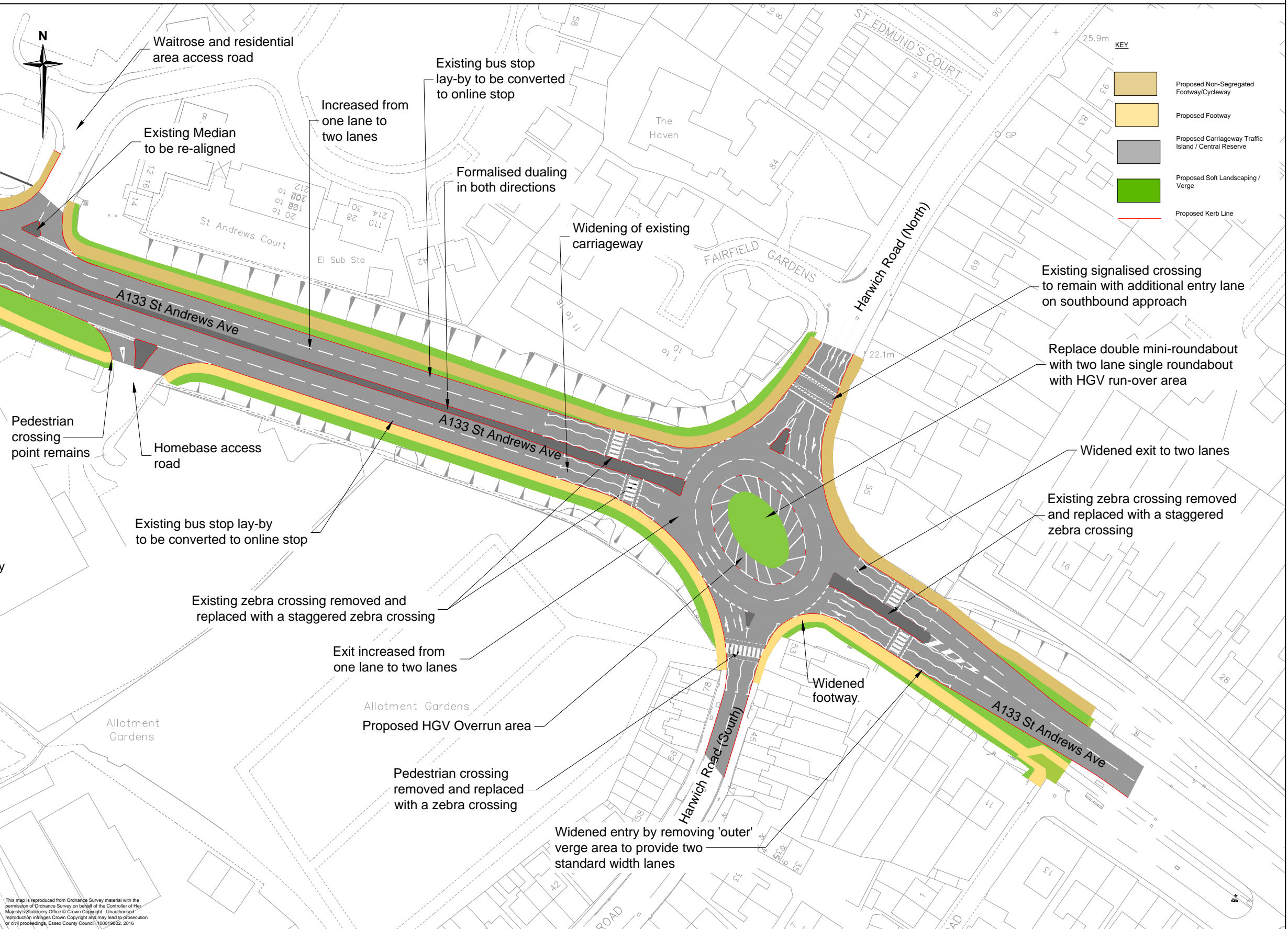

Rev	Date	Description of revision	Drawn	Checked	Reviewed	Approved
1	23/09/16	Website Issue	TP	TC	TC	GW
0	22/09/16	Public Consultation Event	TP	TC	TC	GW

DRAWING STATUS						
CONSULTATION						



Integrated expertise

Mark Rowe, Service Director, Highways  
Seax House, Victoria Road South, Chelmsford, CM1 1QH.  
Tel: 0345 6037631  
© Essex County Council

SCHEME TITLE

**A133 IPSWICH ROAD SCHEME  
MAIN WORKS**

DRAWING TITLE

**HARWICH ROAD ROUNDABOUT -  
ST ANDREWS AVENUE**

DESIGNED	DRAWN	CHECKED	REVIEWED	APPROVED
TP	TP	TC	TC	GW
DATE	DATE	DATE	DATE	DATE
23/09/16	23/09/16	23/09/16	23/09/16	23/09/16

DRAWING UNITS U.N.O.  
DIMENSIONS IN METERS  
LEVELS IN METERS

SCALE AT A1 (841X594mm)  
1:500

DRAWING No.	REV.
DC20050-00-002	1

This map is reproduced from Ordnance Survey material with the permission of Ordnance Survey on behalf of the Controller of Her Majesty's Stationery Office © Crown Copyright. Unauthorised reproduction infringes Crown Copyright and may lead to prosecution or civil proceedings. Essex County Council, 100019602, 2016